

CHAINS

RESTORED CORNER FOR OREGON STATE BOARD OF FORESTRY

Section corner common to Sections 5, 6, 31 and 32, T. 2N., R. 9W, W.M., Tillamook County, Oregon. 1.W. 9 2.N. 9

ORIGINAL

Stone, 18" x 10" x 10" (now missing, corner point located in slide) from which a:

- 54" Spruce bears N. 52° W. 75 lks. (slope distance) now 61" snag; scribes 2N R9 BT visible, rest partly burnt off and partly unexposed.
- 22" Hemlock bears N. 26° E. 41 lks.; now 15" stub 10" high, scribes and face burnt off.
- 30" Hemlock bears S. 67° E. 39 lks.; now 29" snag, scribes and face rotted and burnt off.
- 26" Hemlock bears S. 51° W. 58 lks.; now 27" stub 15" high, face and scribes burnt off.

RESTORED

Var. 21-1/2E.

Set 1 1/2" x 36" galvanized iron pipe with 3" bronze cap marked "OREGON STATE BOARD OF FORESTRY T2N R9W S31 S32 S6 S5 T1N 1956 RS359," 35 inches in ground, in mound of stone, and from which a:

- 3" Fir bears S. 43° W. 12.5 ft.; scribed X BT.
- 5" Fir bears N. 18° E. 30.7 ft.; scribed T2N R9W S32 BT.
- 63" x 56" exposed rock face bears N. 12° W. 10.7 ft.; chiseled BO.
- 35" Fir snag bears S. 12° E. 52.9 ft.; scribed T1N R9W S5 BT RS359.

Oregon State Board of Forestry metal location poster on 4" Fir N. 15° E. 15.6 ft.  
Set 4 x 4 x 72" white painted cedar post 1.5 ft. SE of pipe.

Dated May 14, 1956.

Restored by Richard Morris under my direction.  
Richard Morris, Transitman

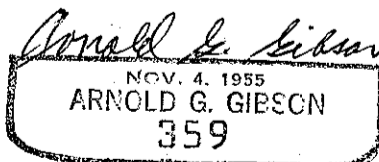
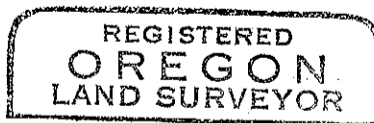

Present and witnessed by W. Phelps, L. Geraths  
W. Peterson, R. Sturm